



# Quick Guide - EN

## Etac Turner Pro

**etac®**

QG61001 - 2024-05-28 - Rev. 1.0

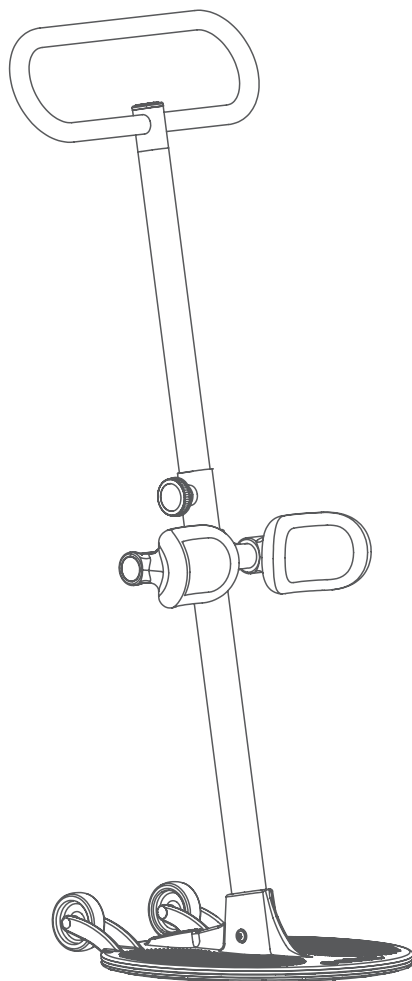

[www.etac.com](http://www.etac.com)



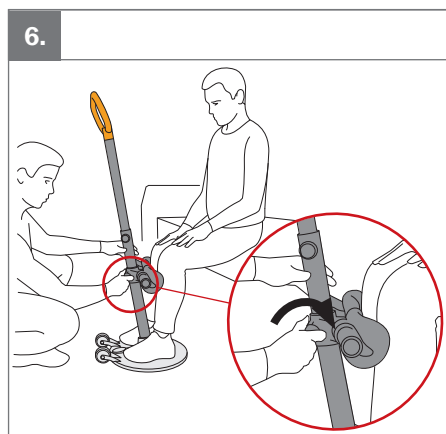
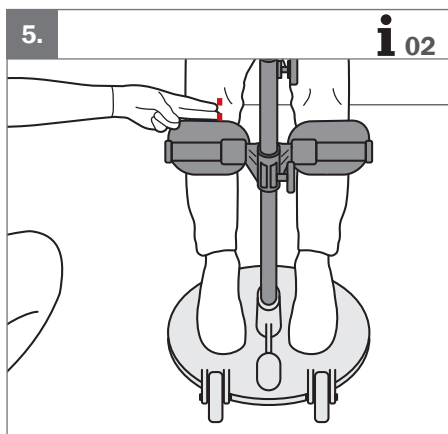
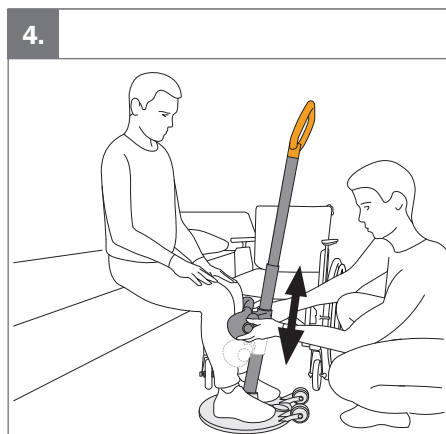
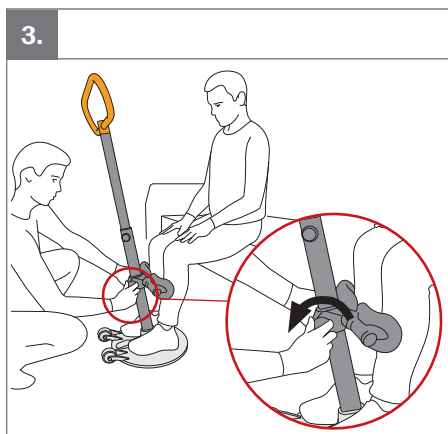
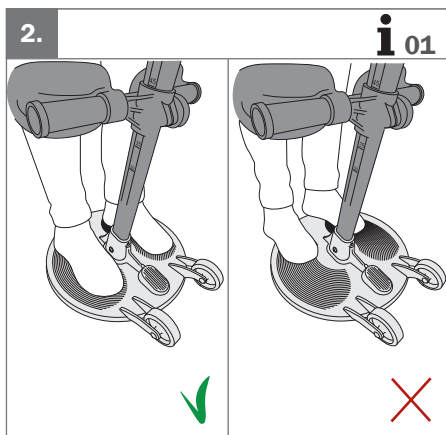
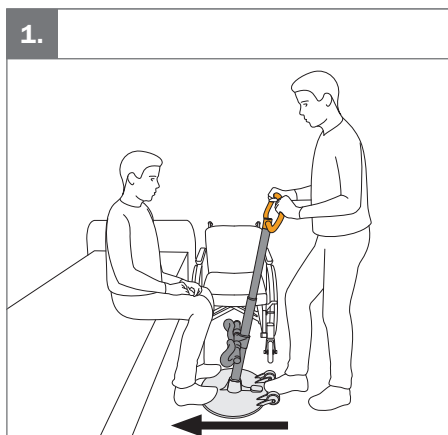

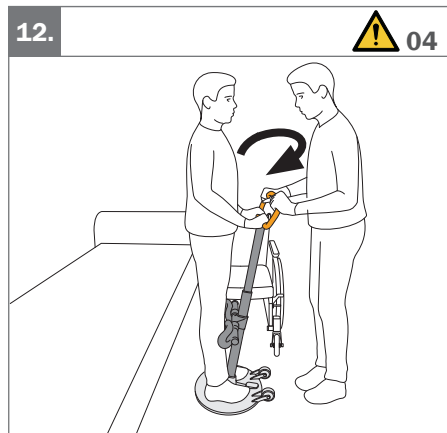
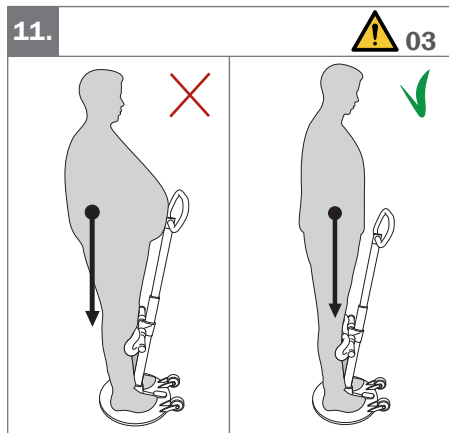
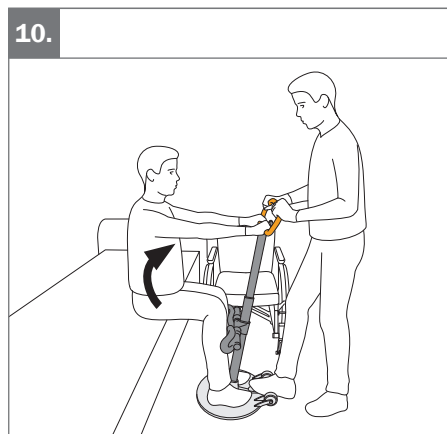
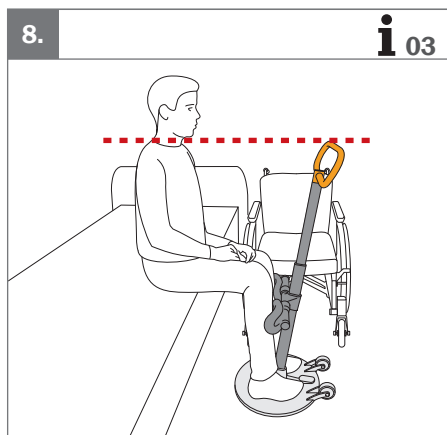
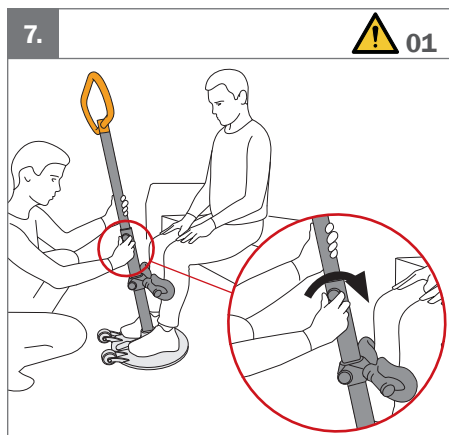



1.

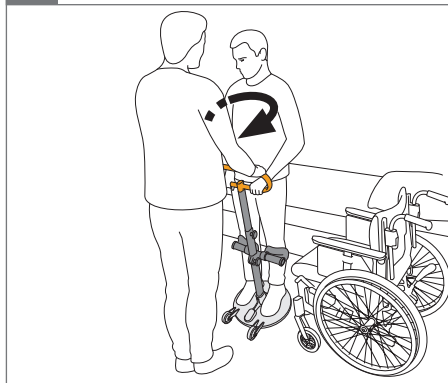

2.



3

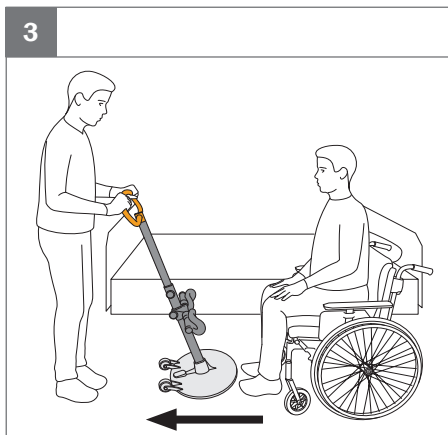

## Handling



### Warnings

01. Hold on to the inner pole with handle when adjusting the height. The handle can slide down unintentionally.
02. The carer must always place one foot on the baseplate and counterbalance the user's weight when the user stands up or sits down.
03. Make sure the user's weight is centred above the centre of the base plate.
04. The user should always hold on to the handles during transfer.



### Information

01. Feet must be placed on the contour on the baseplate.
02. Adjust the legsupport, so it is placed two fingers below the user's knees.
03. Adjust the height of the handle, so it is level with user's shoulder.

## Technical data



This is a Quick Guide. The latest version of all user manuals can be downloaded as a "pdf-file" from the [www.etac.com](http://www.etac.com)

## Cleaning



**Etac A/S**

Parallevej 3

DK-8751 Gedved



+45 796 858 33



[patienthandling@etac.com](mailto:patienthandling@etac.com)



[www.etac.com](http://www.etac.com)

**etac®**